

1

- | REVISIONS | | | |
|-----------|---|-----------|----------|
| REV. | DESCRIPTION | DATE | APPROVED |
| 00 | INITIAL RELEASE FOR MANUFACTURING | DEC2001 | J.KNAPP |
| A | Updated sheet format, corrected title block and revision block author information, changed Flange OD from 17.26" to 17.18", changed ID from 16.08" to 15.99", changed Flange Radius from 0.22" to 0.20", added Straight Wall ref dimension. | 17JAN2019 | R.DAVIS |
| B | Changed Flange OD from 17.18" to 17.23", changed OAH from 10.08" to 9.90" | MAR2019 | R.DAVIS |

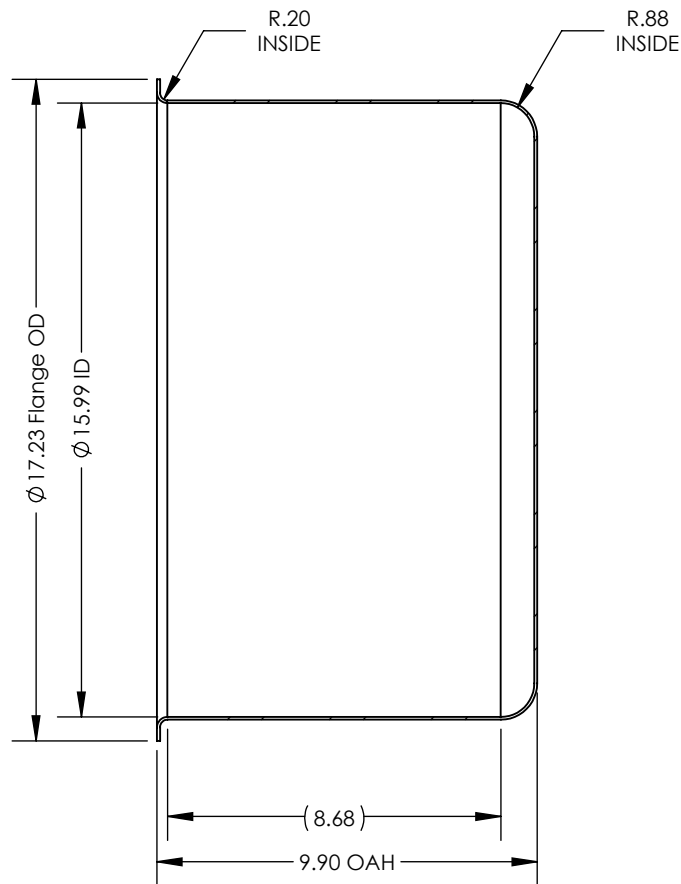

UNLESS OTHERWISE SPECIFIED:
1. DO NOT SCALE DRAWING
2. DIMENSIONS ARE IN INCHES
3. TOLERANCE:
 FRACTIONAL $\pm .25$
 X.X $\pm .1$
 X.XX $\pm .03$
 X.XXX $\pm .010$
 ANGULAR: ± 2 DEG.
4. INTERPRET DRAWING PER
 ASME-Y14.5M-1994 STANDARDS
5. THIRD ANGLE PROJECTION
6. REMOVE BURRS & BREAK ALL
 SHARP EDGES WITH R0.03 ± 0.02

	NAME	DATE
DRAWN	R.DAVIS	MAR2019
CHECKED		
ENG APPR.		
MFG APPR.		
Q.A.		

PROPRIETARY AND CONFIDENTIAL

THE INFORMATION CONTAINED WITHIN THIS DRAWING IS THE SOLE PROPERTY OF TOLEDO METAL SPINNING COMPANY. ANY REPRODUCTION IN PART OR AS A WHOLE WITHOUT WRITTEN PERMISSION OF TOLEDO METAL SPINNING COMPANY IS PROHIBITED.

16" CUP WITH 10" OVERALL HEIGHT

DRAWING NUMBER
TMSCUP16914 REV B

REV
B

SHEET 1 OF 1