

REVISIONS

- | REV. | DESCRIPTION | DATE | APPROVED |
|------|-----------------------------------|----------|--------------|
| A | INITIAL RELEASE FOR MANUFACTURING | MAR2019 | R.DAVIS |
| B | UPDATED DRAWING TO CURRENT FORMAT | 8/4/2020 | K.DRUMHILLER |

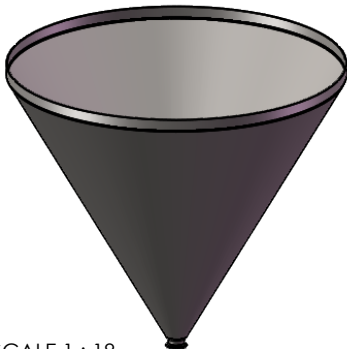
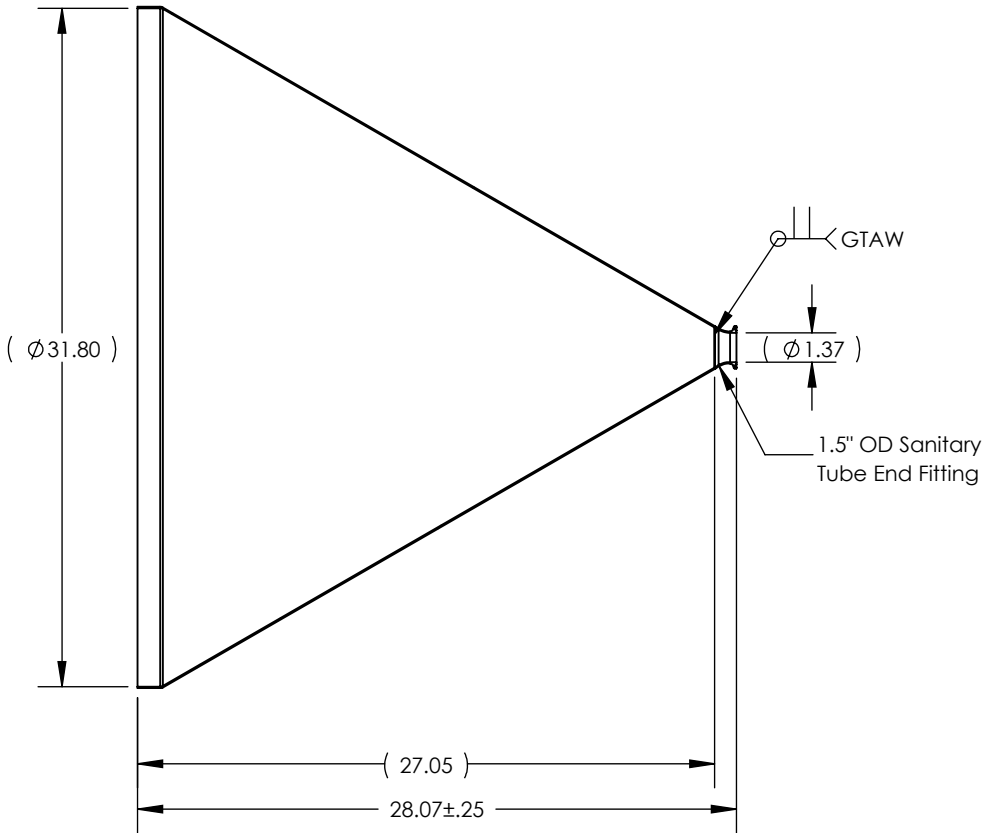

SCALE 1 : 18

SECTION A-A

UNLESS OTHERWISE SPECIFIED:

1. DO NOT SCALE DRAWING
2. DIMENSIONS ARE IN INCHES
3. TOLERANCE:
FRACTIONAL: $\pm .25$
X.X $\pm .1$
X.XX $\pm .03$
X.XXX $\pm .010$
ANGULAR: ± 2 DEG.
4. INTERPRET DRAWING PER
ASME-Y14.5M-1994 STANDARDS
5. THIRD ANGLE PROJECTION
6. REMOVE BURRS & BREAK ALL
SHARP EDGES WITH R0.03 $\pm .02$

	NAME	DATE
DRAWN	R.DAVIS	MAR2019

PROPRIETARY AND CONFIDENTIAL

THE INFORMATION CONTAINED WITHIN THIS
DRAWING IS THE SOLE PROPERTY OF
TOLEDO METAL SPINNING COMPANY. ANY
REPRODUCTION IN PART OR AS A WHOLE
WITHOUT WRITTEN PERMISSION OF TOLEDO
METAL SPINNING COMPANY IS PROHIBITED

TITLE:

HOPPER WITH WELDED 1.5" TUBE FITTING

SIZE A	DRAWING NUMBER 104015		REV B
SCALE: 1:9		WEIGHT: 30.06	SHEET 1 OF 1